

REV.	DESCRIPTION	DATE	APRVD
A	INITIAL RELEASE	05/03/08	---

**WIRING TABLE**

CON	TB
1	TB1-5
2	TB1-4
3	TB1-3
4	TB1-2
5	TB1-1
6	TB2-4
7	TB2-3
8	TB2-2
9	TB2-1

**NOTE**

- 1) TERMINAL BLOCKS WILL ACCOMODATE WIRE GA 30AWG-16AWG
- 2) #4-40 JACKSCREWS AND SHOULDER SCREWS SUPPLIED IN BAG

**SUGGESTED CUTOUT**

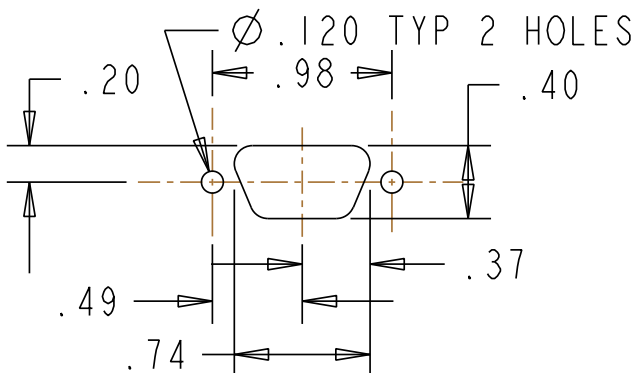

THE CONFIDENTIAL INFORMATION CONTAINED IN THIS DRAWING IS THE PROPERTY OF BTX TECHNOLOGIES, INC. ANY REPRODUCTION IN PART OR IN WHOLE WITHOUT THE WRITTEN PERMISSION OF BTX TECHNOLOGIES, IS PROHIBITED.

**PART DIMENSIONAL TOLERANCES**

ALL DIMENSIONS ARE INCHES [mm]  
 .XX = ±.015 [0.4mm]  
 .XXX = ±.005 [0.1mm]  
 ANGULAR = ±1/2°

**DO NOT SCALE FROM DRAWING**

DRAWN:	CWD	DATE:	05/03/08
APRVD:	---	DATE:	MM/DD/YYYY
FIRST PRODUCT:	-----		



5 SKYLINE DRIVE, HAWTHORNE NY. 10532  
 (914) 592-1800 WWW.BTX.COM

**CUSTOMER DRAWING, 9 PIN MALE**

DRAWING SCALE	1 = 1	FILENAME:	CD-DB9MSLIM	SHEET	#1 OF 1	DATE	05/03/08
---------------	-------	-----------	-------------	-------	---------	------	----------

RoHS COMPLIANT?	SIZE	DOC#	REVISION
YES	A	11- CD-SLIM9M	A