

Atlona HDMI Distribution Amplifier Family



Atlona HDMI Distribution Amplifier Family



Finally, a Distribution Amp for Ultra HD

Ultra HD (4Kx2K) is the highest currently available resolution and Atlona's HDDA family is the first distribution amplifier available on the market that supports it (supports lower resolutions too). Ideal for TV showrooms with displays demonstrating cutting edge Ultra HD resolution. Optimal for digital signage applications that utilize Ultra HD. Analog audio de-embedding allows input to a commercial sound system in a sports bar or other hospitality or entertainment venue.

Atlona Advantages	
PASSES ULTRA HD (4Kx2K)	LINK STATUS LED for source and outputs
ADVANCED EDID MANAGEMENT Learns reference EDID from first output device connected	SUPPORTS 3D up to 48-bit Deep Color
PASSES DOLBY TrueHD, DTS-HD Master Audio	OPTIONAL REDUNDANT POWER SUPPLY (16- and 8-zone models only)
AUDIO DE-EMBEDDING via 1 x S/PDIF and 1 x balanced audio captive screw (16- and 8-zone models only)	LOCKING HDMI and power connectors
CASCADE up to 8 HDDAs for large systems	USB PORT for updates in the field
DUAL PURPOSE WALL MOUNT/RACK BRACKETS for 16-, 8-, and 4-zone models	EASY INTEGRATION via Velcro strips and captive screw power termination (2-zone model only)

Atlona 1 x 2 HDMI Distribution Amplifier



AT-HDDA-2

Family Comparison Chart						
SOLUTIONS	REDUNDANT POWER SUPPLY	CAPTIVE SCREW POWER	SIZE	INPUTS	OUTPUTS	WALL MOUNT/ RACK BRACKETS
AT-HDDA-16	x		1 RU	1 x HDMI	16 x HDMI 1 x S/PDIF 1 x balanced audio captive screw	x
AT-HDDA-8	x		1 RU	1 x HDMI	8 x HDMI 1 x S/PDIF 1 x balanced audio captive screw	x
AT-HDDA-4			1 RU	1 x HDMI	4 x HDMI	x
AT-HDDA-2		x	H x W x D .98 x 4 x 6 in. (23 x 103 x 152 mm)	1 x HDMI	2 x HDMI	x

Specifications				
BANDWIDTH	10.2 Gbps			
RESOLUTION	Ultra HD (4Kx2K)			
PORTS	AT-HDDA-16	AT-HDDA-8	AT-HDDA-4	AT-HDDA-2
Video input	1 x HDMI	1 x HDMI	1 x HDMI	1 x HDMI
Video output	16 x HDMI	8 x HDMI	4 x HDMI	2 x HDMI
S/PDIF	1 x	1 x	none	none
Analog balanced audio output	1 x	1 x	none	none
Firmware update	Mini USB Port	Mini USB Port	Mini USB Port	Mini USB Port
Size	1 U, 19 in. standard electronics rack	1 U, 19 in. standard electronics rack	1 U, 19 in. standard electronics rack	1.98 x 4.06 x 6.1 in. (25 x 103 x 155 mm)
Weight	2.84 kg 6.26 lb.	2.74 kg 6.04 lb.	2.7 kg 5.95 lb.	.12 kg .26 lb.
POWER CONSUMPTION	28.2W	14W	5W	2.31W
TEMPERATURE	Operating: 50°F to 104°F (10°C to 40°C) Storage: 32°F to 122°F (0°C to 50°C)			
CERTIFICATIONS	CE, FCC, (power supply also cULus certified)			

System Connection Diagram

— Video
— Audio

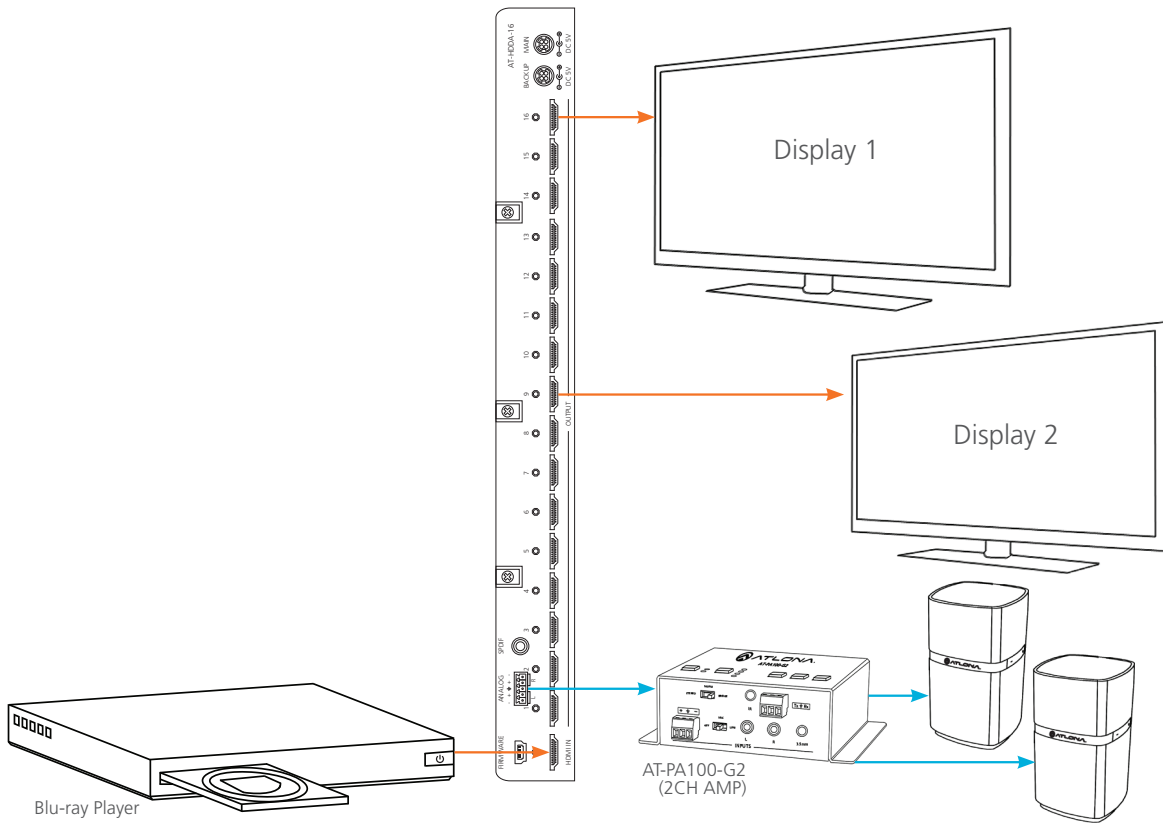
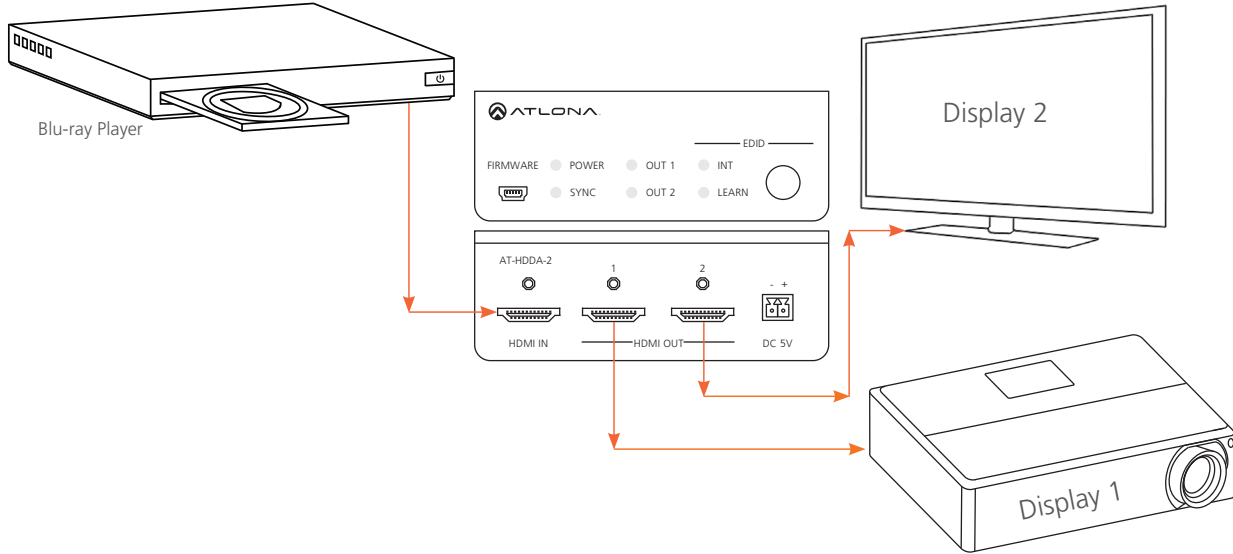

Related Products

When greater distance than possible with traditional HDMI cables are required, Atлона’s HDBaseT extender family is an ideal solution. Use Atлона’s HDBaseT distribution amplifier family when all outputs require greater distance than possible with HDMI cables. Atлона’s H2H matrix switcher family can be used to route different sources to multiple HDDAs. In a sports bar, for example, HDDAs will distribute four different games from four set-top boxes to multiple displays.

Atлона 2 x 8 HDMI to HDBaseT Extended Distance Distribution Amplifier



AT-HDCAT-8ED

Atлона 2 x 8 HDMI to HDBaseT Distribution Amplifier



AT-HDCAT-8

Atлона 2 x 4 HDMI to HDBaseT Distribution Amplifier



AT-HDCAT-4

Related Products (continued)

Atlona HDBaseT RX HDMI Box



AT-HDRX

Atlona HDBaseT TX HDMI Box



AT-HDTX

Atlona 8 x 8 HDMI Matrix Switcher



AT-H2H88M

Atlona 4 x 4 HDMI Matrix Switcher



AT-H2H44M